

Haier

HTF-540DGG7

HTF-540DP7

HTF-520WP7

HTF-520IP7



Refrigerator
User Guide

Kühlschrank
Bedienungsanleitung

Réfrigérateur
Mode d'emploi

Frigorifero
Guida per l'utente

Frigorífico
Manual del usuario

Frigorífico
Guia do Utilizador

Koelvriescombinatie
Handleiding

Lodówka
Podręcznik użytkownika

Congelator
Manual de utilizare

Chladnička
Uživatelská příručka

Hűtőszekrény
Felhasználói útmutató

ΨΥΓΕΙΟ
ΟΔΗΓΙΕΣ ΧΡΗΣΗΣ

ХЛАДИЛНИК
РЪКОВОДСТВО НА ПОТРЕБИТЕЛЯ

EN

DE

FR

IT

ES

PT

NL

PL

RO

CZ

HU

EL

BG



EN WARNING: Risk of fire/flammable material. The symbol indicates there is a risk of fire since flammable materials are used. Take care to avoid causing a fire by igniting flammable material.

DE WARNUNG: Brandgefahr/ brennbares Material. Das Symbol weist auf Brandgefahr hin, da brennbare Materialien verwendet werden. Verhindern Sie die Entstehung von Bränden, die durch entflammbare Materialien verursacht werden.

FR ATTENTION: Risque d'incendie ou de matières inflammables. Le symbole montre qu'il y'a le risque de matériaux inflammables sont utilisés. Prendre soin d'éviter de provoquer un incendie en ingérant des matières inflammables.

IT ATTENZIONE: Rischio di incendio/materiale infiammabile. Il simbolo indica il rischio di incendio nel caso di utilizzo di materiali infiammabili. Fare attenzione ed evitare l'insorgere di incendi a causa della combustione di materiali infiammabili.

ES ADVERTENCIA: Riesgo de incendio o material inflamable. El símbolo indica que existe riesgo de incendio, dado que se utilizan materiales inflamables. Se debe procurar evitar incendios mediante la combustión de materiales inflamables.

PT ADVERTÊNCIA: Risco de incêndio/material inflamável. O símbolo indica que existe um risco de incêndio uma vez que são usados materiais inflamáveis. Ter cuidado para evitar provocar um incêndio por acender material inflamável.

NL WAARSCHUWING: Brandrisico / brandbaar materiaal. Het systeem geeft aan dat er een brandrisico bestaat aangezien brandbaar materiaal wordt gebruikt. Zorg ervoor dat er geen brand wordt veroorzaakt door brandbaar materiaal te ontsteken.

PL OSTRZEŻENIE: Ryzyko pożaru/materiał łatwopalny. Symbol wskazuje, że istnieje ryzyko pożaru, ponieważ używane są materiały łatwopalne. Dbaj o to, aby uniknąć pożaru poprzez zapale nie łatwopalnego materiału.

RO AVERTISMENT: Risc de incendiu/material inflamabil. Simbolul indică că există risc de incendiu deoarece sunt folosite materiale inflamabile. Aveți grijă și evitați incendiile aprinzând materiale inflamabile

CZ VAROVÁNÍ: Nebezpečí Požáru/ Hořlavého Materiálu. Symbol označuje riziko požáru, protože byly použity hořlavé materiály. Dbejte na to, aby nedošlo ke vzniku požáru zapálením hořlavého materiálu.

HU FIGYELEM: Tűz / gyúlékony anyag veszélye. A szimbólum azt jelzi, hogy tűzveszély áll fenn, mivel gyúlékony anyagokat használnak. Úgyeljen arra, hogy ne tegyen rá tűzveszélyes gyúlékony anyagot.

EL ΠΡΟΣΟΧΗ: Κίνδυνος φωτιάς/εύφλεκτο υλικό. Το σύμβολο υποδεικνύει ότι υπάρχει κίνδυνος φωτιάς επειδή χρησιμοποιούνται εύφλεκτα υλικά. Προσέχετε να αποφεύγετε την πρόκληση φωτιάς από ανάφλεξη εύφλεκτου υλικού.

BG ВНИМАНИЕ: Опасност от пожар / запалим материал. Символът показва, че има риск от пожар, тъй като се използват запалими материали. Внимавайте да не се предизвика пожар чрез попадане на запалим материал.



User Manual

Refrigerator-Freezer

HTF-540DGG7

HTF-540DP7

HTF-520WP7

HTF-520IP7

EN

Haier

Thank you for purchasing a Haier Product.

Please read these instructions carefully before using this appliance. The instructions contain important information which will help you get the best out of the appliance and ensure safe and proper installation, use and maintenance.

Keep this manual in a convenient place so you can always refer to it for the safe and proper use of the appliance.

If you sell the appliance, give it away, or leave it behind when you move house, make sure you also pass this manual so that the new owner can become familiar with the appliance and safety warnings.



Legend

Warning – Important Safety information



General information and tips



Environmental information



Disposal

Help protect the environment and human health. Put the packaging in applicable containers to recycle it. Help to recycle waste of electrical and electronic appliances. Do not dispose appliances marked with this symbol with the household waste. Return the product to your local recycling facility or contact your municipal office.



WARNING!

Risk of injury or suffocation!

Refrigerants and gases must be disposed of professionally. Ensure that the tubing of the refrigerant circuit is not damaged before being properly disposed of. Disconnect the appliance from the mains supply. Cut off the mains cable and dispose of it. Remove the trays and drawers as well as the door catch and seals, to prevent children and pets to get closed in the appliance.

Old appliances still have some residual value. An environmentally friendly method of disposal will ensure that valuable raw materials can be recovered and used again.

Cyclopentane, a flammable substance not harmful to ozone, is used as an expander for the insulating foam.

By ensuring this product is disposed of correctly, you will help prevent potential negative consequences for the environment and human health, which could otherwise be caused.

For more detailed information about recycling of this product, please contact your local council, your household waste disposal service or the shop where you purchased the product, handled by the professionals.

Safety information	4
Intended use.....	9
Product description.....	11
Control panel.....	12
Use.....	13
Equipment	23
Care and cleaning.....	26
Troubleshooting	28
Installation.....	31
Technical data	35
Customer service.....	37

Accessories

Check the accessories and literature in accordance with this list:



Water pipe



Water filter



1/2" adapter with valve



3 spacers



2 clips



Egg tray



Ice shovel



Energy-label



Warranty card



User manual

Before switching on the appliance for the first time read the following safety hints!:



WARNING!

Before first use

- ▶ Make sure there is no transport damage.
- ▶ Remove all packaging and keep out of children's reach.
- ▶ Wait at least two hours before installing the appliance in order to ensure the refrigerant circuit is fully efficient.
- ▶ Handle the appliance always with at least two persons because it is heavy.

Installation

- ▶ The appliance should be placed in a well-ventilated place. Ensure a space of at least 10 cm above and around the appliance.
- ▶ Never place the appliance in a damp area or location where it might be splashed with water. Clean and dry water splashes and stains with a soft clean cloth.
- ▶ Do not install the appliance in direct sunlight or in the near of heat sources (e.g. stoves, heaters).
- ▶ Install and level the appliance in an area suitable for its size and use.
- ▶ Keep ventilation openings in the appliance or in the in-built structure clear of obstruction.
- ▶ Make sure that the electrical information on the rating plate agrees with the power supply. If it does not, contact an electrician.
- ▶ The appliance is operated by a 220-240 VAC/50 Hz power supply. Abnormal voltage fluctuation may cause the appliance to fail to start, or damage to the temperature control or compressor, or there may be an abnormal noise when operating. In such case, an automatic regulator shall be mounted.
- ▶ Do not use multi-plug adapters and extension cables.
- ▶ Do not locate multiple portable socket-outlets or portable power supplies at the rear of the appliance.
- ▶ Ensure that the power cable is not trapped by the refrigerator. Do not step on the power cable.

**WARNING!**

- ▶ Use a separate earthed socket for the power supply which is easy accessible. The appliance must be earthed.

Only for UK: The appliance's power cable is fitted with 3-cord (grounding) plug that fits a standard 3-cord (grounded) socket. Never cut off or dismount the third pin (grounding). After the appliance is installed, the plug should be accessible.

- ▶ Do not damage the refrigerant circuit.

Daily use

- ▶ This appliance can be used by children aged from 8 years and above and persons with reduced physical, sensory or mental capabilities or lack of experience and knowledge if they have been given supervision or instruction concerning use of the appliance in a safe way and understand the hazards involved.
- ▶ Children aged from 3 to 8 years are allowed to load and unload, but not allowed to clean or install the refrigerating appliances.
- ▶ Keep away children under 3 years of age from the appliance unless they are constantly supervised.
- ▶ Children shall not play with the appliance.
- ▶ If cool gas or other inflammable gas is leaking in the vicinity of the appliance, turn off the valve of the leaking gas, open the doors and windows and do not unplug a plug in the power cable of the refrigerator or any other appliance.
- ▶ Notice that the appliance is set for operation at a specific ambient range between 10 and 43°C. The appliance may not work properly if it is left for a long period at a temperature above or below the indicated range.
- ▶ Do not place unstable articles (heavy objects, containers filled with water) on top of the refrigerator, to avoid personal injury caused by falling or electric shock caused by contact with water.
- ▶ Do not pull on the door shelves. The door may be pulled slant, the bottle rack, may be pulled away, or the appliance may topple.
- ▶ Open and close the doors only with the handles. The gap between the doors and between the doors and the cabinet is very narrow. Do not extend your hands in these areas to avoid pinching your fingers. Open or close the refrigerator doors only when there are no children standing within the range of door movement.



WARNING!

- ▶ Do not store or use inflammable, explosive or corrosive materials in the appliance or in the vicinity.
- ▶ Do not store medicines, bacteria or chemical agents in the appliance. This appliance is a household appliance. It is not recommended to store materials that require strict temperatures.
- ▶ Never store liquids in bottles or cans (besides high percentage spirits) especially carbonated beverages in the freezer, as these will burst during freezing.
- ▶ Check the condition of food if a warming in the freezer has taken place.
- ▶ Do not set unnecessarily low temperature in the refrigerator compartment. Minus temperatures may occur at high settings. Attention: Bottles can burst
- ▶ Do not touch frozen goods with wet hands (wear gloves). Especially do not eat ice lollies immediately after removal from the freezer compartment. There is the risk to freeze or the formation of frost blisters. FIRST aid: keep immediately under running cold water. Do not pull away!
- ▶ Do not touch the inside surface of the freezer storage compartment when in operation, especially with wet hands, as your hands may freeze onto the surface.
- ▶ Unplug the appliance in the event of a power interruption or before cleaning. Allow at least 7 minutes before restarting the appliance, as frequent starting may damage the compressor.
- ▶ Do not use electrical devices inside the food storage compartments of the appliance, unless they are of the type recommended by the manufacturer.

Maintenance / cleaning

- ▶ Make sure children are supervised if they carry out cleaning and maintenance.
- ▶ Disconnect the appliance from the electrical supply before undertaking any routine maintenance. Allow at least 7 minutes before restarting the appliance, as frequent starting may damage the compressor.

**WARNING!**

- ▶ Hold the plug, not the cable, when unplugging the appliance.
- ▶ Do not clean the appliance with hard brushes, wire brushes, detergent powder, petrol, amyl acetate, acetone and similar organic solutions, acid or alkaline solutions. Please clean with special refrigerator detergent to avoid damage.
- ▶ Do not scrape off frost and ice with sharp objects. Do not use sprays, electric heaters like heater, hair dryer, steam cleaners or other sources of heat in order to avoid damage to the plastic parts.
- ▶ Do not use mechanical devices or other means to accelerate the defrosting process, other than those recommended by the manufacturer.
- ▶ If the supply cord is damaged, it must be replaced by the manufacturer, its service agent or similarly qualified persons in order to avoid a hazard.
- ▶ Do not try to repair, disassemble or modify the appliance by yourself. In case of repair please contact our customer service.
- ▶ Eliminate the dust on the back of the unit at least once in the year to avoid hazard by fire, as well as increased energy consumption.
- ▶ Do not spray or flush the appliance during cleaning.
- ▶ Do not use water spray or steam to clean the appliance.
- ▶ Do not clean the cold glass shelves with hot water. Sudden temperature change may cause the glass to break.

Refrigerant gas information



WARNING!

The appliance contains the flammable refrigerant ISOBUTANE (R600a). Make sure the refrigerant circuit is not damaged during transportation or installation. Leaking refrigerant may cause eye injuries or ignite. If a damage has occurred, keep away open fire sources, thoroughly ventilate the room, do **not** plug or unplug the power cords of the appliance or any other appliance. Inform the customer service.

In case of eyes get into contact with the refrigerant, rinse immediately it under running water and call immediately the eye specialist.

Intended use

This appliance is intended for cooling and freezing food. It has been designed exclusively for use in household and similar applications such as staff kitchen areas in shops, offices and other working environments; farm houses and by clients in hotels, motels and other residential type environments as well as in bed-and-breakfast and catering business. It is not intended for commercial or industrial use.

Changes or modifications to the device are not allowed. Unintended use may cause hazards and loss of warranty claims.

Standards and directives

This product meets the requirements of all applicable EC directives with the corresponding harmonised standards, which provide for CE marking.



CAUTION!

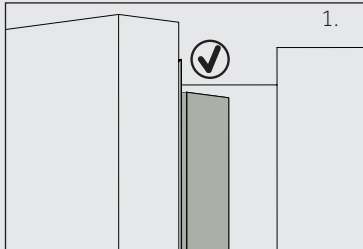

When you close the door, the vertical door strip on the left door should be bent inside (1).

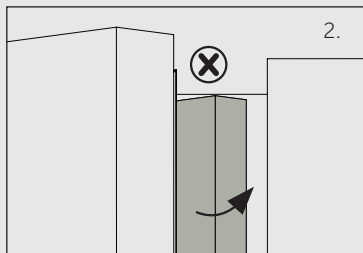

If you try to close the left door and the vertical door strip is unbent (2), you should bend it firstly, otherwise the door strip will hit the fixing shaft or right door. Thus a damage to the door slip or a leak will occur.

There is a heating thread inside the frame. The temperature of the surface will rise a little, which is normal and won't affect the function of appliance.



Notice

Due to technical changes and different models, some of the illustrations in this manual may differ from your model.

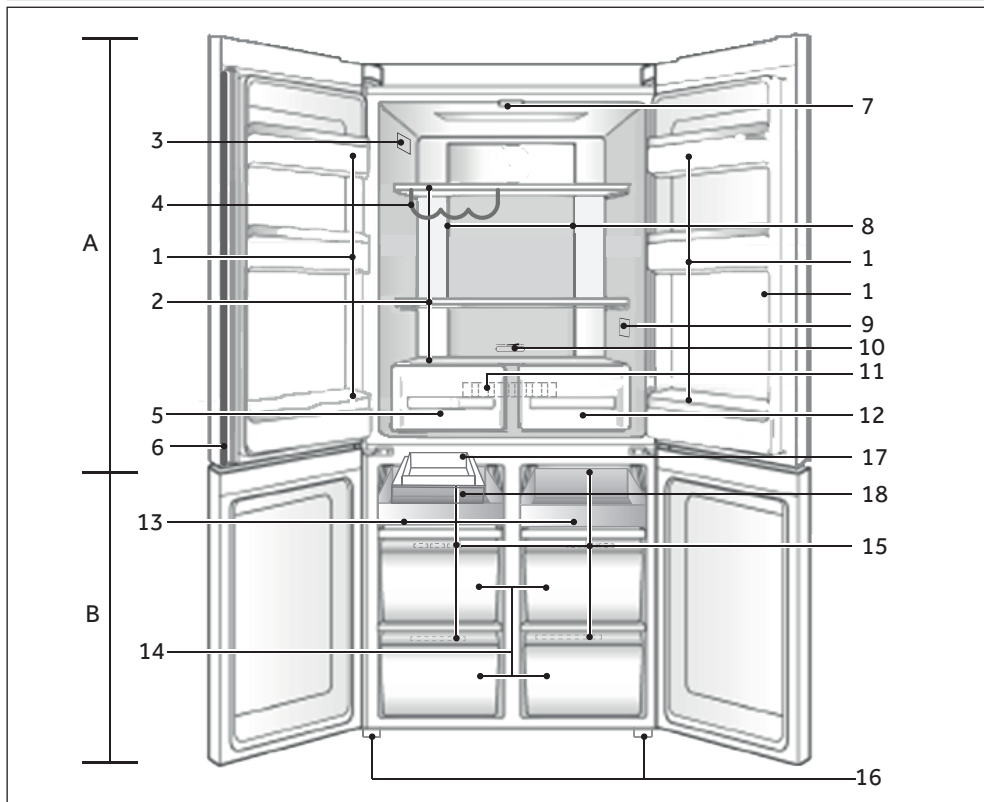

A: Refrigerator compartment

- 1 Bottle holder/Door rack
- 2 Glass shelves
- 3 Rating plate
- 4 Wine rack
- 5 Humidity box
- 6 Vertical beam
- 7 Ceiling lamp
- 8 Air duct and sensor (behind panel)
- 9 O.K.-temperature indicator (optional)
- 10 MyZone slider
- 11 Air duct (behind drawers)
- 12 MyZone box

B: Freezer compartment

- 13 Sliding shelf
- 14 Freeze box
- 15 Air duct
- 16 Adjustable feet
- 17 Auto ice maker (HTF-520IP7)
- 18 Ice tray (HTF-520IP7)
- 19 Water dispensing (HTF-520IP7/HTF-520WP7)

Control panel

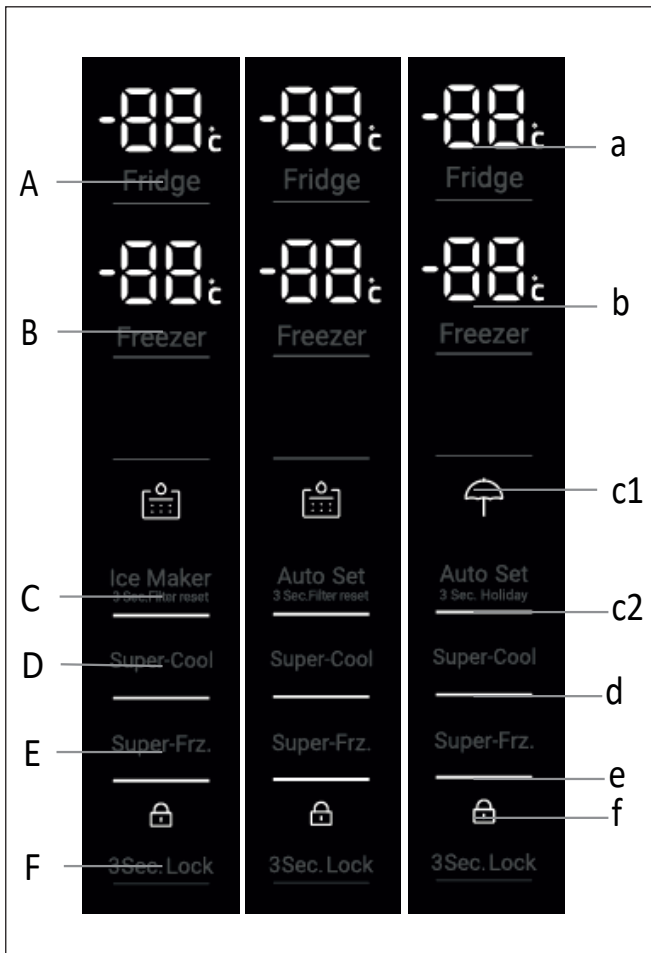

Buttons:

- A Fridge selector
- B Freezer selector
- C Auto Set mode and holiday function selector (HTF-540DGG7/ HTF-540DP7)
Auto Set mode and filter reset function selector (HTF-520WP7)
Ice maker mode and filter reset function selector (HTF-520IP7)
- D Super-Cool selector
- E Super-Freeze selector
- F Panel lock selector

Indicators:

- a Temperature fridge
- b Temperature freezer
- c1 Holiday mode (HTF-540DGG7/ HTF540DP7)
Water filter alarm (HTF-520IP7/ HTF-520WP7)
- c2 Auto Set mode
- d Super-Cool function
- e Super-Freeze function
- f Panel lock

Before first use

- ▶ Remove all packaging materials, keep them out of children`s reach and dispose them in an environmentally friendly manner.
- ▶ Clean the inside and outside of the appliance with water and a mild detergent before putting any food in it.
- ▶ After the appliance has been levelled and cleaned, wait for at least 2-5 hours before connecting it to the power supply. See Section INSTALLATION.
- ▶ Precool the compartments at high settings before loading with food. The function Power- Freeze helps to cool down the freezer compartment quickly.
- ▶ The refrigerator temperature and freezer temperature are automatically set to 5° C and -18° C respectively. These are the recommended settings. If desired, you can change these temperatures manually. Please see ADJUST THE TEMPERATURE.

Before first use the Ice and Water or Automatic Ice function

Before first use, you need to flush water through the filter to remove impurities or trapped air in the water tank and filter system.

For Ice and Water

- Press the water dispenser pad to dispense 4L of water - wait for 4 minutes before dispensing again.
- Dispense 4L of water and then wait for another 4 minutes - There may be carbon residue dispensed together with water. This is not harmful and normal during the flushing process.
- Dispense another 4 L of water. - This prevents excessive dripping of water from your dispenser.
- There may be a few drips of water coming out of the dispenser for a few days after installation. This is to clear the remaining trapped air in the dispenser.
- Ensure your refrigerator has cooled for at least 2 hours before use.



For Automatic Ice model

- 1 Press control panel button „C“ to turn on the ice maker function.
- 2 Discard the first full bin of ice made. Clean the ice box with water and install it back. Your ice maker is now ready for use.
- 3 Repeat step 2 to remove dust in the ice tray collected during manufacture and transport.
- 4 Empty the water, dry the bin and return it correctly.
- 5 Once your Ice maker is turned on the first bin of ice may be discoloured. This is not harmful and normal during the flushing process. Discard the first full bin of ice made. Your Ice maker is now ready for use.



Notice

The performance of your water filter will increase with use, reaching optimum performance after two to three full bins of ice.

Sensor keys

The buttons on the control panel are sensor keys, which already respond when lightly touched with the finger.

Switch on /off the appliance

The appliance is in operation as soon as it is connected to the power supply.

When the appliance is powered on for the first time, the actual refrigerator and freezer temperatures are displayed. The display will flash. If the doors are closed it will switch off after 30 seconds.

Maybe the panel lock is active.



Notice

- ▶ The appliance is preset to the recommended temperature of 5°C (refrigerator) and - 18°C (freezer). Under normal ambient condition you need not to set a temperature.
- ▶ When the appliance is switched on after disconnection from the main power supply, it may take up to 12 hours for the correct temperatures to be reached.

Empty the appliance before switching off. To switch off the appliance, pull the power cord out of the power socket.

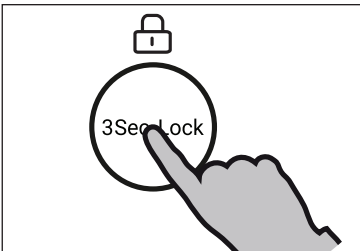

Lock/unlock panel



Notice

The control panel is automatically blocked against activation if the doors are closed and 30 seconds no button is pressed. For any settings the control panel must be unlocked.

- ▶ Touch button "F" for 3 seconds to block all panel elements against activation. The buzzer alarms and the related indicator "f" is now displayed; the lighting of the panel is switched off. The icon flashes if a button will be pressed, when the panel lock is activated. The change is not running.
- ▶ For unlocking press again the button.

Standby-mode

The display screen turns off automatically 30 seconds after pressing a key. The display will be automatically locked. It lights up automatically when pressing any key or opening any door (Alarm does not light up the display screen).

Select the working mode

You may need to select one of the following two ways to set the appliance:

1) Auto Set mode

Under Auto Set mode, the appliance can automatically adjust the temperature setting according to the ambient temperature and temperature change in the appliance. If you do not have any special requirements, we recommend that you use Auto Set mode (refer to Auto Set mode later on).

2) Manual adjusting mode:

If you want to manually adjust the temperature of the appliance in order to store a particular food, you can set the temperature via a temperature adjusting button (refer to ADJUST THE TEMPERATURE).

Door opening alarm

When the refrigerator door is opened for more than 1 minute, the door opening alarm will sound. The alarm can be silenced by either closing the door or touching the control panel. If the door is left open for more than 7 minutes, the light inside the compartment and control panel illumination will automatically switch off.



Adjust the temperature

The indoor temperatures are influenced by the following factors:

- ▶ Ambient temperature
- ▶ Frequency of door opening
- ▶ Amount of stored foods
- ▶ Installation of the appliance

Adjust the temperature for fridge

1. Unlock the panel by pressing button "F" if it is locked.
2. Press button „A" (Fridge) for select the fridge compartment. An alarm sounds. The actual temperature in the refrigerator compartment is displayed.
3. Press button "A" to set the fridge temperature. A signal will sound at each key press. The temperature increases in sequences of 1°C from a minimum of 1°C (OF) to a maximum of 9°C, switching to 1°C again when pressing further. The optimum temperature in the refrigerator is 5 °C. Colder temperatures mean unnecessary energy consumption.

If no key is operated in 5 sec., the setting confirms automatically.

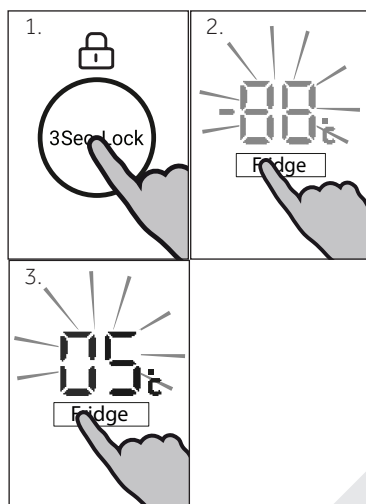

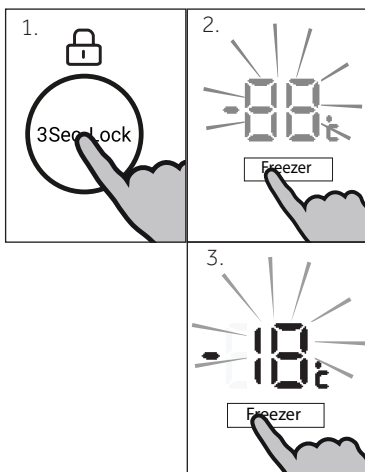

Adjust the temperature for freezer

- Unlock the panel by pressing button "F" if it is locked.
- Press button "B" (Freezer) for select the freezer compartment. An alarm sounds. The actual temperature in the freezer compartment is displayed.
- Press button "B" (Freezer) to set the freezer temperature. A signal will sound at each key press. The temperature increases in sequences of 1°C from a minimum of -14°C to a maximum of -24°C, switching to -14°C again when pressing further. The optimum temperature in the freezer is -18°C. Colder temperatures mean unnecessary energy consumption.

If no key is operated in 5 sec., the setting confirms automatically.



Notice

The temperature in the corresponding compartment cannot be adjusted if any other function (Power-Freeze, Super-Cool, Holiday or Auto Set mode) is activated or the display is locked. The corresponding indicator will flash accompanying with a buzzer.

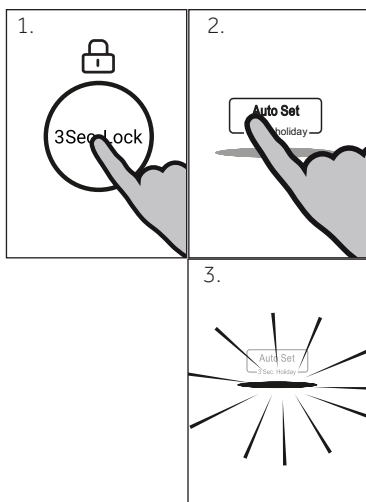

Auto Set mode

In the Auto Set mode, the appliance can automatically adjust the temperature setting according to the ambient temperature and temperature change in the appliance. This function is totally hand free.

- Unlock the panel by pressing button "F" if it is locked.
- Press button "C" (Auto Set). An alarm sounds.
- Indicator "c2" illuminates and the function is activated.

By repeating the above steps or selecting an other function this function can be switched off again.

Ice Maker mode

Under the Ice Maker mode, the refrigerator starts the automatic ice making function. When the ice box is full of ice, the process of ice making will stop.

1. Ensure the current situation is unlocked.
2. Press "C" (Ice Maker) and the buzzer make sound.
3. The indicator "c2" will lights up and starts the automatic ice making function.

In order to turn off the ice making function, also press "C" (Ice Maker) under the unlocked situation. The Ice Maker mode and the Quick cooling / freezing mode can be turned on at the same time.

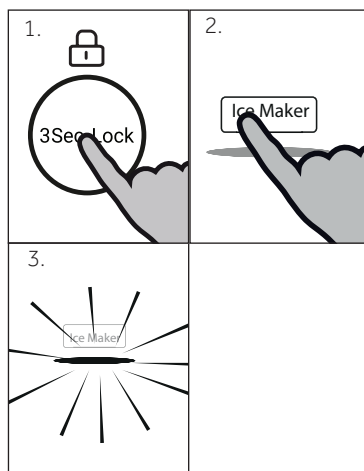

Holiday function

This function sets the refrigerator temperature permanently to 17°C.

This allows to keep the door of the empty refrigerator closed without causing an odour or mold - during a long absence (e.g. during holiday). The freezer compartment is free for your setting.

1. Unlock the panel by pressing button "F" if it is locked.
2. Press button "C" (Auto Set) for 3 seconds.
3. Indicator "c1" illuminates and the function is activated.

By repeating the above steps or selecting an other function this function can be switched off again.

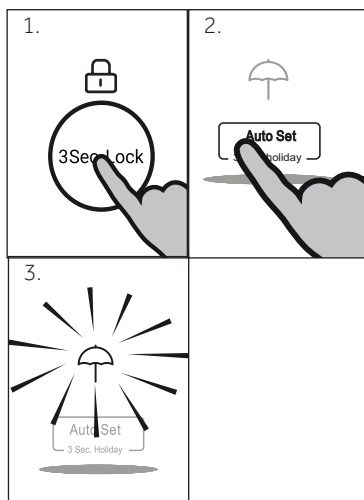

WARNING!

During the holiday function no goods must be stored in the refrigerator compartment. The temperature of + 17 °C is too high for storing food.

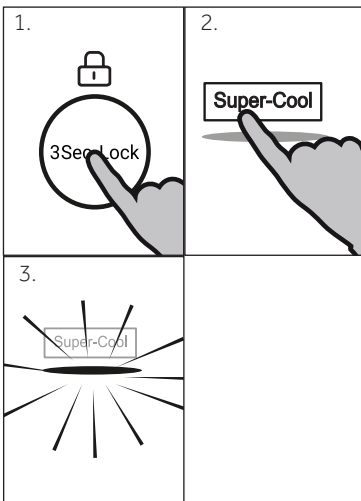

Super-Cool function

Switch on the Super-Cool function if larger quantity of food should be stored (for example after the purchase). The Power-Cool function accelerates the cooling of fresh food and protects the goods already stored from undesirable warming. The factory setting temperature is 0 to +1°C.

1. Unlock the panel by pressing button "F" if it is locked.
2. Press button "D" (Super-Cool).
3. Indicator "d" illuminates and the function is activated.

By repeating the above steps or selecting an other function this function can be switched off again.



Notice

This function will be automatically disabled after 3 hours.



Using water dispenser (Water dispensing models only)

Ensure you have followed the steps outlined in "Before you start using the Ice and Water or Automatic Ice function" prior to your first use of water dispenser.

Dispensing

Your water dispenser is designed for one-handed operation. To dispense water, gently press the dispensing pad with a glass or container. To stop the flow of water, simply pull your glass or container away from the dispenser pad. Pressing hard against the dispensing pad will not increase the flow or dispense more water.



WARNING!

To avoid damage to property or personal injury do not put hands, fingers or objects up the dispenser opening.

Using ice maker (Ice and Water and Automatic Ice models only)

Ice On/Off

Your ice maker is designed to automatically dispense ice into the ice storage bin below until it detects the bin is full. The more ice you use, the more it makes.

First Use

The ice maker will be off when you turn your refrigerator on for the first time after installation. The light above the „Ice On/Off“ icon will be off.

1. Press control panel button „C“ to turn on the ice maker function.
2. Discard the first full bin of ice made. Clean the ice box with water and install it back. Your ice maker is now ready for use.
3. Repeat step 2 to remove dust in the ice tray collected during manufacture and transport.
4. Empty the water, dry the bin and return it correctly.
5. Once your ice maker is turned on the first bin of ice may be discoloured. This is not harmful and normal during the flushing process. Discard the first full bin of ice made. Your ice maker is now ready for use.

Carry out the above steps after a holiday/vacation or extended periods of not using ice.



Notice

The performance of your water filter will increase with use, reaching optimum performance after two to three full bins of ice.

Turn ice maker off if:

- There is no water supply for several hours.
- You are removing the ice storage bin for a period of time.
- You are going on holiday/vacation.

Information about the ice maker

- Your automatic ice maker will produce approximately eight cubes of ice every 2 hours, depending on the freezer compartment temperature and the number of door openings.
- The ice cube tray will fill with water.
- When cubes are frozen, they will be ejected from the ice tray into the ice storage bin.
- Ice making will continue until the storage bin is full.
- Ice making will resume once you start to use the stored ice.
- Your Ice and Water product comes with a smaller ice bin inside the larger freezer bin.
- Attached to the ice storage bin is the scoop for the ice. This scoop provides hygienic access to the ice.
- If a large amount of ice is required, remove an ice storage bin and allow ice to fall into the larger bin.
- If ice is not used often, old cubes will become cloudy, taste stale, will shrink and may stick together. Empty the ice storage bin periodically and wash in lukewarm water. Dry thoroughly and place back into the correct position.



WARNING!

- ▶ Avoid contact with the moving parts of the ice maker ejector mechanism, and do not place your fingers on the automatic ice making mechanism while the refrigerator is in operation.
- ▶ Do not use ice cubes that may have become discoloured, usually with a green-blue colour. If such discolouration is noted, discard the ice cubes and contact your Haier trained and supported service technician.
- ▶ Ensure the ice maker is connected to the filter and to a drinkable water supply only.
- ▶ Installation of the water connection to the ice maker must be completed by a Haier trained and supported service technician or a qualified plumber.

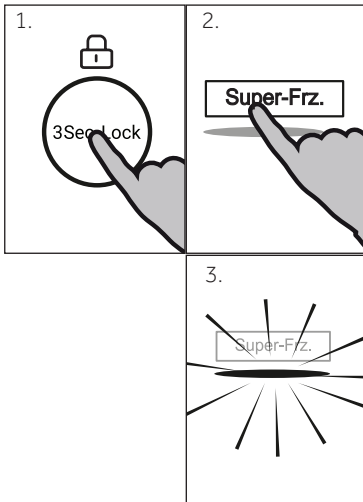

Super-Freeze function

Fresh food should be frozen as quickly as possible to the core. This preserved the best nutritional value, appearance and taste. The Super-Freeze function accelerates the freezing of fresh food and protects the goods already stored from undesirable warming. If you need to freeze a large amount of food once, it is recommended to set the Super-Freeze function on ahead for 24 h before the usage of frozen room. The function setting temperature is below -24°C .

1. Unlock the panel by pressing button "F" if it is locked.
2. Press button "E" (Super-Freeze).
3. Indicator "e" illuminates and the function is activated.

By repeating the above steps or selecting an other function this function can be switched off again.



Notice

The Super-Freeze function will automatically switch off after 50 hours. The appliance is then operated at the previously set temperature.



WARNING!

- ▶ Empty the appliance before switching off.
- ▶ Keep the door of the refrigerating compartment open, when Refrigerator off function is activated, in order to avoid odour or mold..

Tips on storing fresh food

Storing into the refrigerator compartment

- ▶ Keep your fridge temperature below 5°C.
- ▶ Hot food must be cooled to room temperature before storing in the appliance.
- ▶ Foods stored in the refrigerator should be washed and dried before storing
- ▶ Food to be stored should be properly sealed to avoid odour or taste alterations.
- ▶ Do not store excessive quantities of food. Leave spaces between foods to allow cold air flowing around them, for a better and more homogeneous cooling.
- ▶ Foods eaten daily should be stored at the front of the shelf.
- ▶ Leave a gap between foods and the inner walls, allowing air flowing. In special way don't store foods against the rear wall: foods could freeze against rear wall. Avoid direct contact of food (especially oily or acidic food) with the inner liner, as oil/acid can erode the inner liner. Clean away oily/acid dirt whenever it is found.
- ▶ Defreeze frozen food in the fridge storage compartment. This way, you can use the frozen food to decrease the temperature in the compartment and save energy.
- ▶ The ageing process of fruit and vegetables such as courgettes, melons, papaya, banana, pineapple, etc. can be accelerated in the refrigerator. Therefore, it is not advisable to store them in the refrigerator. However, the ripening of strongly green fruits can be promoted for a certain period. Onions, garlic, ginger and other root vegetables should also be stored at room temperature.
- ▶ Unpleasant odours inside the fridge are a sign that something has spilled and cleaning is required. See CARE AND CLEANING.
- ▶ Different foods should be placed in different areas according to their properties:



Notice

- ▶ Please keep the distance more than 10 mm between the food placed and air duct or sensors to ensure the cooling effect.

- 1 Butter, cheese, etc.
- 2 Eggs, cans, canned food, spices, etc.
- 3 Drinks and bottled foods.
- 4 Pickled foods, canned food, etc.
- 5 Meat products, snack foods, pasta, canned food, milk, tofu, dairy etc.
- 6 Cooked meat, sausages, etc.
- 7 My Zone drawer : dry fruits, butter oils, chocolate
- 8 Humidity box drawer: Fruit, vegetables, salad, etc.

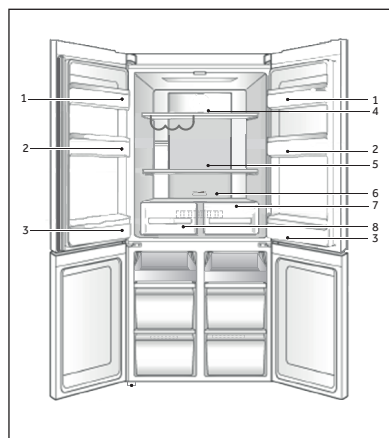

Storage into the freezer compartment

- ▶ Keep the freezer temperature at -18°C.
- ▶ 24 hours before freezing switch on the Power-freeze function; -for small quantities of food 4-6 hours are sufficient.
- ▶ Hot food must be cooled to room temperature before storing in the freezer compartment.
- ▶ Food cut into small portions will freeze faster and be easier to defrost and cook. The recommended weight for each portion is less than 2.5 kg
- ▶ It is better to pack food before putting it into the freezer. The outside of the packaging must be dry to avoid bags sticking together. Packaging materials should be odour-free, airtight, non-poisonous and nontoxic.
- ▶ In order to avoid expiration of storage periods, please note the freezing date, time limit and name of the food on the packaging according to the storage periods of different foods.
- ▶ **WARNING!:** Acid, alkali and salt etc. could erode the internal surface of the freezer. Do not place the food having these substances (e.g. sea fish) directly on the internal surface. Salt water in the freezer should be cleaned up immediately.
- ▶ Do not exceed the food storage times recommended by the manufacturers. Only take the required amount of food out of the freezer.
- ▶ Consume defrosted food quickly. Defrosted food cannot be re-frozen unless it is first cooked, otherwise it may be inedible.
- ▶ Do not load excessive quantities of fresh food in the freezer compartment. Refer to the freezing capacity of the freezer – See TECHNICAL DATA or data at the type plate.
- ▶ Food can be stored in the freezer at a temperature of at least -18°C for 2 to 12 months, depending on its properties (e.g., meat: 3-12 months, vegetables: 6-12 months)
- ▶ When freezing fresh food, avoid bringing it in contact with already frozen food. Risk of thawing!

When storing commercially frozen foods, please follow these guidelines:

- ▶ Always follow manufacturers' guidelines for the length of time you should store food for. Do not exceed these guidelines!
- ▶ Try to keep the length of time between purchase and storage as short as possible to preserve food quality.
- ▶ Buy frozen foods, which have been stored at a temperature of -18 °C or below.
- ▶ Avoid buying food which has ice or frost on the packaging – This indicates that the products might have been partially defrosted and refrozen at some point – temperature rises affect the quality of food.



Notice

- ▶ Please keep the distance more than 10 mm between the food placed and air duct to ensure the cooling effect.

Multi-air-flow

The refrigerator is equipped with a multi-air-flow system, with which cool air flows are located on every shelf level. This helps to maintain a uniform temperature to ensure that your food is kept fresher for longer.

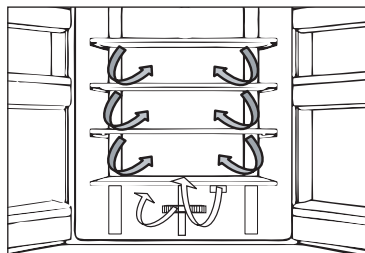

Adjustable shelves

The height of the shelves can be adjusted to fit your storage needs.

1. To relocate a shelf, remove it first by uplifting its hind edge (1) and pulling it out (2).
2. To reinstall it, put it on the lugs on both sides and push it to the most rearward position until the rear of the shelf is fixed inside the slots in the sides.

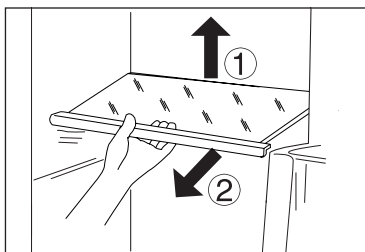

Notice:

Ensure that all ends of a shelf are level.

My Zone drawer

In this compartment the humidity level is lower than fridge compartment. This drawer is suitable to store dry fruit and other dry food with low water content like butter, fats and oils or chocolate.

Humidity box drawer

In this compartment the humidity level is higher than fridge compartment. It is controlled automatically by the system and is suitable to store fruits, vegetables, salads etc.



Notice:

- ▶ Do not remove the plastic cover inside the two zones. They maintain the humidity.
- ▶ Cold-sensitive fruits like pineapple, avocado, bananas, grapefruits and vegetables such as potatoes, aubergines, beans, cucumbers, zucchini and tomatoes and cheese should not be stored in these two drawers.

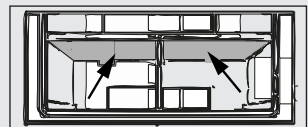

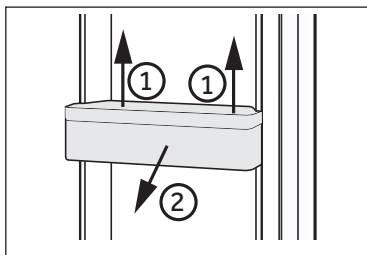

Removable door racks

The door racks can be removed for cleaning:
Place hands on each side of the rack, lift it upwards (1) and pull it out (2).

In order to insert the door rack, the above steps are carried out in reverse order.

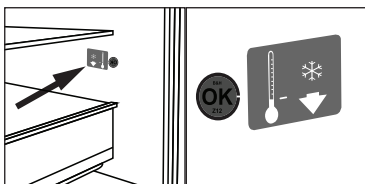

OPTIONAL: OK-temperature indicator

The OK-temperature indicator can be used to determine temperatures below +4°C. Gradually reduce the temperature if the sign does not indicate "OK".



Notice:

When the appliance is switched on, it may take up to 12 hours for the correct temperatures to be reached.

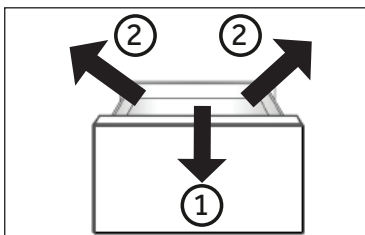

Removable freezer drawer

To remove the drawer out, pull out to the maximum extent (1), lift and remove (2).

In order to insert the drawer, the above steps are carried out in reverse order.

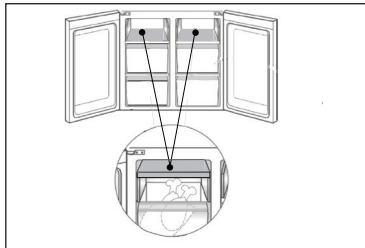

Storing large items

Large items of e.g. frozen food can be stored after:

- ▶ removing and overturning by 180° the upper freezing tray, or
- ▶ after removing both upper freezing trays as well as the middle freezer drawer and storing the food directly on the shelf.

The Light

The LED interior light comes on when the door is opened. The performance of the lights is not affected by any of the appliances other settings.



Energy saving tips

- ▶ Make sure the appliance is properly ventilated (see INSTALLATION).
- ▶ Do not install the appliance in direct sunlight or in the near of heat sources (e.g. stoves, heaters).
- ▶ Avoid unnecessarily low temperature in the appliance. The energy consumption increases the lower the temperature in the appliance is set.
- ▶ Functions like POWER- FREEZE consume more energy.
- ▶ Allow warm food to cool down before placing it in the appliance.
- ▶ Open the appliance door as little and as briefly as possible.
- ▶ Do not overfill the appliance to avoid obstructing the air flow.
- ▶ Avoid air within the food packaging.
- ▶ Keep door seals clean so that the door always closes correctly.
- ▶ Defreeze frozen food in the fridge storage compartment.



WARNING!

Disconnect the appliance from the power supply before cleaning.

Cleaning

Clean the appliance when only little or no food is stored.

The appliance should be cleaned every four weeks for good maintenance and to prevent bad stored food odors.



WARNING!

- ▶ Do not clean the appliance with hard brushes, wire brushes, detergent powder, petrol, amyl acetate, acetone and similar organic solutions, acid or alkaline solutions. Please clean with special refrigerator detergent to avoid damage.
 - ▶ Do not spray or flush the appliance during cleaning.
 - ▶ Do not use water spray or steam to clean the appliance.
 - ▶ Do not clean the cold glass shelves with hot water. Sudden temperature change may cause the glass to break .
 - ▶ Do not touch the inside surface of the freezer storage compartment, especially with wet hands, as your hands may freeze onto the surface.
 - ▶ In case of heating check the condition of frozen goods.
- ▶ Always keep the door gasket clean.
 - ▶ Clean the inside and housing of the appliance with a sponge dampened in warm water and neutral detergent.
 1. Please scrub the interior and exterior of the refrigerator, including door sealing, door rack, glass shelves, boxes and so on, with a soft towel or sponge dipped in warm water (you may add neutral detergent into the warm water).
 2. If there is liquid spilled, remove all the contaminated parts, directly rinse with the flow water, dry and place it back into the fridge.
 3. If there is spilled cream (such as the cream, melting ice cream), please remove all the contaminated parts, put into the warm water with about 40 °C for some time, then rinse with the flow water, dry and place it back into the fridge.
 4. In case some small part or component gets stucked inside of the fridge (between shelves or drawers), use small soft brush to release it. If you could not reach the part, please contact Haier service.
 - ▶ Rinse and dry with soft cloth.
 - ▶ Do not clean any of the parts of the appliance in a dishwasher.
 - ▶ Allow at least 7 minutes before restarting the appliance as frequent starting may damage the compressor.

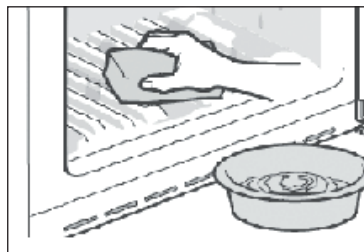

Defrosting

The defrosting of the refrigerator and the freezer compartment are done automatically; no manual operation is needed.

Replacing the LED-lamps



WARNING!

Do not replace the LED lamp yourself, it must only be replaced by either the manufacturer or the authorised service agent.

The lamp adopts LED as its light source, featuring low energy consumption and long service life. If there is any abnormality, please contact the customer service. See CUSTOMER SERVICE.

Parameters of the lamp:

Refrigerator compartment: 12 V max 2 W

Freezer compartment: 12 V max 0,5 W

Non-use for a longer period

If the appliance is not used for an extended period of time, and you will not use only the Holiday-function or the fridge off function for the refrigerator:

- ▶ Take out the food.
- ▶ Unplug the power cord.
- ▶ Empty and clean the watertank
- ▶ Clean the appliance as described above.
- ▶ Keep the doors open to prevent the creation of bad odours inside.



Notice

Turn the appliance off only if strictly necessary.

Moving the appliance

1. Remove all food and unplug the appliance.
2. Secure shelves and other moveable parts in the fridge and the freezer with adhesive tape.
3. Do not tilt the refrigerator more than 45° to avoid damaging the refrigerating system.



WARNING!

- ▶ Do not lift the appliance by its handles.
- ▶ Never place the appliance horizontally on the ground.

Many occurring problems could be solved by yourself without specific expertise. In case of a problem please check all shown possibilities and follow below instructions before you contact an after sales service. See CUSTOMER SERVICE.



WARNING!

- ▶ Before maintenance, deactivate the appliance and disconnect the mains plug from the mains socket.
- ▶ Electrical equipment should be serviced only by qualified electrical experts, because improper repairs can cause considerable consequential damages.
- ▶ A damaged supply should only be replaced by the manufacturer, its service agent or similarly qualified persons in order to avoid a hazard.

Problem	Possible Cause	Possible Solution
The compressor does not work.	<ul style="list-style-type: none"> • Mains plug is not connected in the mains socket. • The appliance is in the defrosting cycle 	<ul style="list-style-type: none"> • Connect the mains plug. • This is normal for an automatic defrosting
The appliance runs frequently or runs for a too long period of time.	<ul style="list-style-type: none"> • The indoor or outdoor temperature is too high. • The appliance has been off power for a period of time. • A door/drawer of the appliance is not tightly closed. • The door/drawer has been opened too frequently or for too long. • The temperature setting for the freezer compartment is too low. • The door/drawer gasket is dirty, worn, cracked or mismatched. • The required air circulation is not guaranteed. 	<ul style="list-style-type: none"> • In this case, it is normal for the appliance to run longer. • Normally, it takes 8 to 12 hours for the appliance to cool down completely. • Close the door/drawer and ensure the appliance is located on a level ground and there is no food or container jarring the door. • Do not open the door/drawer too frequently. • Set the temperature higher until a satisfactory refrigerator temperature is obtained. It takes 24 hours for the refrigerator temperature to become stable. • Clean the door/drawer gasket or replace them by the customer service. • Ensure adequate ventilation.
The inside of the refrigerator is dirty and/or smells.	<ul style="list-style-type: none"> • The inside of the refrigerator needs cleaning. • Food of strong odour is stored in the refrigerator. 	<ul style="list-style-type: none"> • Clean the inside of the refrigerator. • Wrap the food thoroughly..

Problem	Possible Cause	Possible Solution
It is not cold enough inside the appliance.	<ul style="list-style-type: none"> The temperature is set too high. Too warm goods has been stored. Too much food has been stored at one time. The goods are too close to each other. A door/drawer of the appliance is not tightly closed. The door/drawer has been opened too frequently or for too long. 	<ul style="list-style-type: none"> Reset the temperature. Always cool down goods before storing them. Always store small quantities of food. Leave a gap between several foods allowing air flowing. Close the door/drawer. Do not open the door/drawer too frequently.
It is too cold inside the appliance.	<ul style="list-style-type: none"> The temperature is set too low. The Power- freeze function is activated or is running too long. 	<ul style="list-style-type: none"> Reset the temperature. Switch off the Power- freeze function
Moisture formation on the inside of the refrigerator compartment.	<ul style="list-style-type: none"> The climate is too warm and too damp. A door/drawer of the appliance is not tightly closed. The door/drawer has been opened too frequently or for too long. Food containers or liquids are left open. 	<ul style="list-style-type: none"> Increase the temperature. Close the door/drawer. Do not open the door/drawer too frequently. Let hot foods cool to room temperature and cover foods and liquids.
Moisture accumulates on the refrigerator outside surface or between the doors/door and drawer.	<ul style="list-style-type: none"> The climate is too warm and too damp. The door/drawer is not closed tightly. The cold air in the appliance and the warm air outside it condensates. 	<ul style="list-style-type: none"> This is normal in damp climate and will change when the humidity decreases. Ensure that the door/drawer is tightly shut.
Strong ice and frost in the freezer compartment.	<ul style="list-style-type: none"> The goods were not adequately packaged. A door/drawer of the appliance is not tightly closed. The door/drawer has been opened too frequently or for too long. The door/drawer gasket is dirty, worn, cracked or mismatched. Something on the inside prevents the door/drawer to close properly. 	<ul style="list-style-type: none"> Always pack the goods well. Close the door/drawer. Do not open the door/drawer too frequently. Clean the door/drawer gasket or replace them by new ones. Reposition the shelves, door racks, or internal containers to allow the door/drawer to close.
The sides of the cabinet and door strip get warm.	<ul style="list-style-type: none"> - 	<ul style="list-style-type: none"> This is normal.

Problem	Possible Cause	Possible Solution
The appliance makes abnormal sounds.	<ul style="list-style-type: none"> The appliance is not located on level ground. The appliance touches some object around it. 	<ul style="list-style-type: none"> Adjust the feet to level the appliance. Remove objects around the appliance.
A slight sound is to be heard similar to that of flowing water.	<ul style="list-style-type: none"> - 	<ul style="list-style-type: none"> This is normal.
You will hear an alarm beep.	<ul style="list-style-type: none"> The fridge storage compartment door is open. 	<ul style="list-style-type: none"> Close the door or silence the alarm manually.
You will hear a faint hum.	<ul style="list-style-type: none"> The anti-condensation system is working 	<ul style="list-style-type: none"> This prevents condensation and is normal
The interior lighting or cooling system does not work.	<ul style="list-style-type: none"> Mains plug is not connected in the mains socket. The power supply is not intact. The LED-lamp is out of order. 	<ul style="list-style-type: none"> Connect the mains plug. Check the electrical supply to the room. Call the local electricity company! Please call the service for changing the lamp.

Power interruption

In the event of a power cut, food should remain safely cold for about 12 hours. Follow these tips during a prolonged power interruption, especially in summer:

- ▶ Open the door/drawer as few times as possible.
- ▶ Do not put additional food into the appliance during a power interruption.
- ▶ If prior notice of a power interruption is given and the interruption duration is longer than 12 hours, make some ice and put it in a container in the top of the refrigerator compartment.
- ▶ An inspection of the goods is required immediately after the interruption.
- ▶ As temperature in the refrigerator will rise during a power interruption or other failure, the storage period and edible quality of food will be reduced. Any food that defrosts should be either consumed, or cooked and refrozen (where suitable) soon afterwards in order to prevent health risks.

Memory function during power interruption

After restoration of power the appliance continues with the settings that were set before the power failure.

Unpacking



WARNING!

- ▶ The appliance is heavy. Always handle with at least two persons.
 - ▶ Keep all packaging materials out of children's reach and dispose them in an environmentally friendly manner.
- ▶ Take the appliance out of the packaging.
 - ▶ Remove all packaging materials.

Environmental conditions

The room temperature should always be between 10° C and 43° C, since it can influence the temperature inside the appliance and its energy consumption. Do not install the appliance near other heat-emitting appliances (ovens, refrigerators) without isolation.

Space requirement

Required space when door is opened:

W1=1221 mm

W2=1534 mm

D1=560 mm

D2=1040 mm

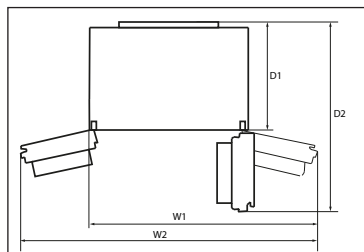

Ventilation cross-section

To achieve sufficient ventilation of the appliance for safety reasons, the information of the required ventilation cross sections must be observed.

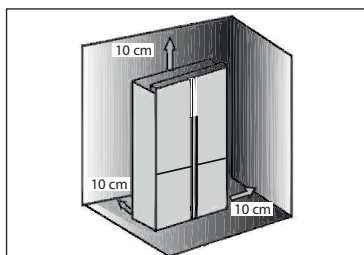

Aligning the appliance

The appliance should be placed on a flat and solid surface.

1. Tilt the appliance slightly backwards.
2. Set the feet to the desired level.

Make sure the distance to the wall on the hinge side is at least 100 mm for the door to open properly.

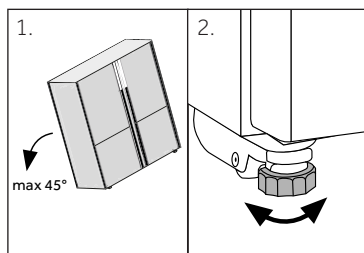

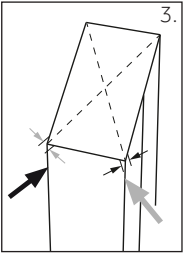

3. The stability can be checked by alternately bumping on the diagonals. The slightly swaying should be the same in both directions. Otherwise the frame can warp; possible leaking door seals are the result. A low tendency to the rear facilitates the closing of the door.

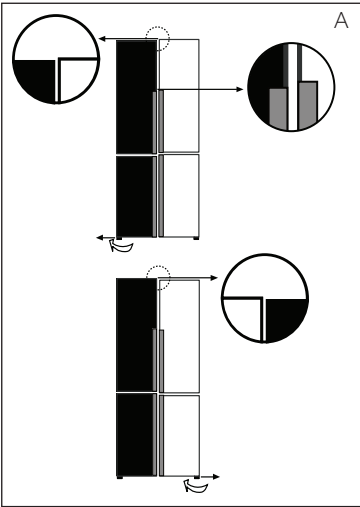

Fine tuning of the doors

If the doors are not in one level, this mismatch can be remedied by following:

A) Using adjustable foot

Rotate the adjustable foot according to the direction of arrow to turn up or down the foot.

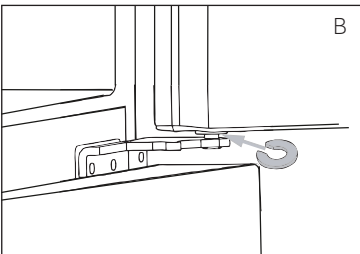

B) Using spacers

- ▶ Open the upper door and lift it.
- ▶ Carefully clip the spacer (enclosed in the accessory bag) in the white plastic ring of the middle hinge by hand or using tools like pliers. Do not scratch or bruise the door.



Notice

In the future use of refrigerator, doors uneven phenomenon may occur to the weight of stored food. Then please adjust according to the above methods.

Waiting time

To the maintenance-free lubrication oil is located in the capsule of the compressor. This oil can get through the closed pipe system during slanting transport. Before connecting the appliance to the power supply you have to wait 2-5 hours so that the oil runs back into the capsule.

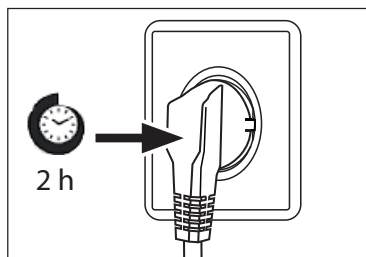

Electrical connection

Before each connection check if:

- ▶ power supply, socket and fusing are appropriate to the rating plate.
- ▶ the power socket is earthed and no multi-plug or extension.
- ▶ the power plug and socket are strictly according.

Connect the plug to a properly installed household socket.



WARNING!

To avoid risks a damaged power cord must be replaced by the customer service (see warranty card).

Ice and Water and Automatic Ice models

- ▶ Your Ice and Water and Automatic Ice refrigerator must be installed by a qualified plumber or Haier trained and supported service technician as incorrect plumbing can lead to water leaks.
- ▶ Haier appliances does not accept responsibility for damage (including water damage) caused by faulty installation or plumbing.

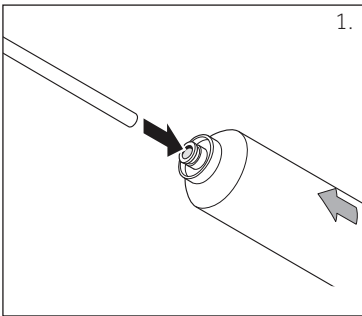

1.

Water Supply Connection



WARNING!

It is recommended to have this product installed by a qualified technician.



Notice

For further installation details refer to the instructions supplied with the water filter.

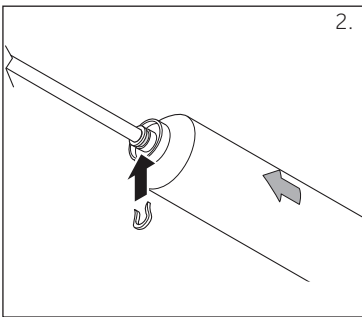

2.

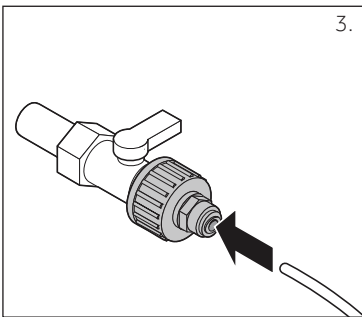

3.

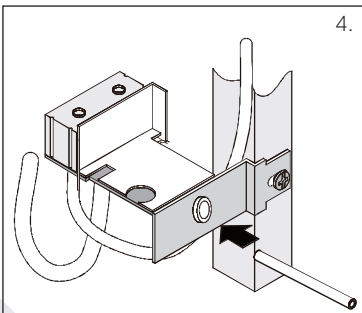

4.

- ▶ Pressure of the cold water supplied to the automatic icemaker is between 0.15-0.6 Mpa.
- ▶ The water tube should be of an appropriate length, usually 8 metres, and should be free of bends after being inserted into place. If the water pipe is too long then the water pressure will be reduced, affecting the ice and cold water content.
- ▶ DO NOT connect to the water supply when the ambient temperature is below 0°C, otherwise the water pipe may freeze.
- ▶ Always connect to the drinking water supply.
- ▶ Keep the water pipe away from heat sources.
- ▶ The water filter is there to filter impurities in the water, and to make ice clean and hygienic. It cannot sterilise or destroy anything, so be certain to connect the water pipe to a drinkable water source.
- ▶ Automatic water system, do not manually add water.
- ▶ If the ice maker is turned on but the appliance is not connected to water, the ice maker will not work.

Fitting the Water Filter

Measure out and cut the length of pipe required from the filter to the Fridge-freezer and from the filter to the water supply. Make sure that you achieve a square cut using a sharp knife. Push fit one of the pipes into the water filter (Fig.1). Secure the pipe to the filter by sliding a locking clip into the groove as shown (Fig. 2). Repeat the procedure on the other end of the filter. Connect the end into the plastic adaptor (Fig.3). Screw the adaptor onto a suitable ½" BSP connector water outlet. Access the water valve assembly at the back of the refrigerator. Push the pipe into the valve assembly (Fig.4).

Commissioning the Water Dispenser

Before first use, press the water dispenser pad several times for 1 minute. Do not press for more than 1 minute to prevent overheating of the pad activator solenoid. Cold water will begin to flow from the outlet.

Product fiche according to regulation EU No. 1060/2010

Brand	Haier
Model name / identifier	HTF-540DGG7/ HTF-540DP7/ HTF-520IP7/ HTF-520WP7
Category of the household refrigerating appliance ⁽¹⁾	7
Energy efficiency class A+++ (most efficient) to D (least efficient)	A++
Energy consumption ⁽²⁾	340/340/339/339
Total net capacity of whole refrigerator compartment	500L/500L/492L/496L
of which chill compartment	26 L
of which wine storage compartment	-
of which cellar-temperature compartment	-
of which fresh food storage compartment	324L/324L/317L/317L
Total number of wine bottles ⁽³⁾	-
Total net capacity of freezer compartment	150L/150L/146L/150L
Star coding ⁽⁴⁾	****
Design temperature of "other compartments" ⁽⁵⁾	-
Lowest storage temperature of wine compartment	-
Frost-free	•
Storage time during malfunctions	12 h
Freezing capacity ⁽⁶⁾	12 kg
Ice making capacity (Only for HTF-520IP7)	1.0 kg/24h
Climate rating ⁽⁷⁾	SN-N-ST-T
Airborne noise emitted	39 dB(A) re 1 pW
Type of appliance	freestanding

Explanations:

• Yes, featured

(1) Household refrigeration categories:

Category=Designation

1=Refrigerator with one or more storage compartments for fresh food, 2=Refrigerator with cellar-temperature zone, cellar-temperature compartment refrigerator and wine cabinet, 3=Refrigerator with cold storage zone and refrigerator with a zero star compartment, 4=Refrigerator with a one-star compartment, 5=Refrigerator with a two-star compartment, 6=Refrigerator with three-star compartment, 7=Fridge-freezer, 8=Freezer, 9=Chest freezer, 10=Multi-purpose refrigerators and other refrigerators

(2) Based on the results of the standards conformance test over 24 hours. The actual consumption depends on the use and the location of the appliance.

(3) The rated capacity is quoted as the number of standard 0.75l bottles that can be stored in the appliance in accordance with the manufacturer's instructions.

(4) * = compartment -6°C or less; *** = frozen-food compartment -18°C or less; **** = food freezer compartment -18°C or less with a minimum freezing capacity.

(5) 'Other compartment' means a compartment, other than a wine storage compartment, intended for the storage of particular

foodstuffs at a temperature warmer than + 14 °C.

- (6) The freezing capacity is achievable for the quantity given according to type of appliance only after switching to permanent operation and cannot be repeated within 24 hours. Please observe the operating instructions.
- (7) Climate rating SN: This appliance is intended for use in an ambient temperature of between + 10°C and +32°C
Climate rating N: This appliance is intended for use in an ambient temperature of between + 16°C and +32°C
Climate rating ST: This appliance is intended for use in an ambient temperature of between + 16°C and +38°C
Climate rating T: This appliance is intended for use in an ambient temperature of between + 16°C and +43°C

Additional technical data

Voltage / Frequency	220-240V ~/ 50Hz
Input current (A)	2
Main fuse (A)	16
Coolant	R600a
Dimensions (H/W/D in mm)	1900 / 905 / 648

Customer Service

We recommend our Haier Customer Service and the use of original spare parts.

If you have a problem with your appliance, please first check section TROUBLESHOOTING.

If you cannot find a solution there, please contact

- ▶ your local dealer or
- ▶ our European Call Service-Center (see listed phone numbers below) or
- ▶ the Service & Support area at www.haier.com where you can activate the service claim and also find FAQs.

To contact our Service, ensure that you have the following data available.

The information can be found on the rating plate.

Model _____

Serial No. _____

Also check the Warranty Card supplied with the product in case of warranty.

European Call Service-Center		
Country*	Phone number	Costs
Haier Italy (IT)	199 100 912	
Haier Spain (ES)	902 509 123	
Haier Germany (DE)	0180 5 39 39 99	<ul style="list-style-type: none"> • 14 Ct/Min Landline • max 42 Ct/Min Mobile
Haier Austria (AT)	0820 001 205	<ul style="list-style-type: none"> • 14,53 Ct/Min Landline • max 20 Ct/Min all others
Haier United Kingdom (UK)	0333 003 8122	
Haier France (FR)	0980 406 409	

* For other countries please refer to www.haier.com

Haier Europe Trading S.r.l

Branch UK

Westgate House, Westgate, Ealing

London, W5 1YY

HTF-540_EN_V08_190415

Haier

