

Be Your Window To The World



Selling Points

PRO AP241Z 5M

- Windows 11 Home- MSI consiglia Windows 11 Pro per le aziende
 - 23.8" IPS Retroilluminazione a LED del pannello (1920 x 1080 FHD)
 - Processori AMD Ryzen serie 5000 con memoria DDR4
 - MSI Anti-sfarfallio e amp; Le tecnologie Less Blue Light proteggono gli occhi degli utenti
 - 178° schermo ad ampio angolo di visione
 - Il design FW TPM protegge i tuoi dati riservati con chiavi di crittografia
 - Assembla e smonta il supporto con un design senza strumenti
 - Silent PRO Cooling System: Il modulo termico di grado server garantisce un funzionamento silenzioso e stabile con un ciclo di vita più lungo
- *I tempi di aggiornamento possono variare in base al dispositivo. Le funzionalità e la disponibilità delle app possono ...



Picture and logos

System I/O-Ports

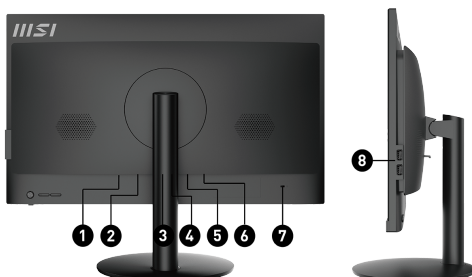

1. DC Jack
2. 1x HDMI out (2.0)
3. 1x COM port
4. 4x USB 3.2 Gen 1 Type A
5. 1x RJ45
6. 1x Mic-in/ 1x Line-out
7. 1x Kensington lock
8. 2x USB 2.0 Type A

Specification

| | | |
|-------------------|----------------------------------|---------------------------|
| Operating Systems | Windows | Windows 11 Pro |
| Display | Screen Size | 23.8" (60cm) |
| | Active Display Area (mm) | 527.04(H) x 296.46(V) |
| | Curvature | Flat |
| | Panel Type | IPS |
| | Resolution | 1920x1080 (FHD) |
| | Pixel pitch | 0.2745(H)x0.2745(V) |
| | Brightness (nits) | 250 |
| | Contrast Ratio | 1200:1 |
| | Signal Frequency | N/A |
| | Response Time (GTG) | 14ms |
| | View Angles | 178°(H)/178°(V) |
| | Touch Screen | Non-touch |
| | Display Colors | 16.7M |
| I/O Ports | Lock type | Kensington |
| Processor | CPU model | AMD Ryzen 5 5600G |
| | CPU Clock | 3.9GHz |
| | CPU Cores | 6 |
| | CPU TDP | 65W |
| | CPU Cache | 3MB |
| | CPU Threads | 12 |
| Chipset | Motherboard Chipset | A520 |
| Memory | Memory Capacity | 8GB(8GB*1) |
| | Memory Type | DDR4 SDRAM |
| | Memory Speed | 1600(3200)MHz |
| | Memory Module Form Factor | SO-DIMM |
| | Memory Slot (Total/Free) | 2/1 |
| | Memory Max Capacity | Max 64GB |
| Storage | Total SSD Storage Capacity | 256GB |
| | Total HDD Storage Capacity | N/A |
| | M.2 Slot (1) Installed SSD | 256GB*1 |
| | M.2 Slot (1) Interface | PCIe GEN3x4 w/o DRAM NVMe |
| | M.2 Slot (1) Form Factor | M.2-2280 M-KEY |
| | M.2 slots (Total/Free) | 1/0 |
| | HDD (1) RPM | N/A |
| | HDD (1) Form Factor | N/A |
| | HDD (1) Interface | N/A |
| | 3.5" Drive Bays (Total/Free) | 0/ |
| | 2.5" Drive Bays (Total/Free) | 1/1 |
| | ODD(Type) | N/A |
| | ODD Height | N/A |
| ODD Type | N/A | |
| Communications | LAN Controller | Realtek RTL8111H |
| | Wireless LAN Controller | INTEL/3168.NGWW |
| | Wireless LAN standard | 802.11ac 1x1+BT |
| | Bluetooth Version | 4.2 |
| Audio | Audio Codec | Realtek ALC897 |
| | Audio Support | 2.1 Channel HD Audio |
| I/O Ports (Front) | USB 480Mbps (USB 2.0) | 2 |
| I/O Ports (Rear) | USB 5Gbps (USB 3.2 Gen 1 Type-A) | 4 |
| | LAN Ports (RJ45) | 1 |
| | HDMI™ | 1x (v1.4) |
| | COM Port | 1 |
| Power | AC Adapter Output | 120W |
| | Battery | N/A |
| | Battery Whrs | N/A |



BUSINESS & PRODUCTIVITY PC ALL-IN-ONE

PRO AP241Z 5M

PRO AP241Z 5M-051EU

| | | |
|--------------------------------------|--|--|
| In The Box | Keyboard Interface | WIRELESS |
| | Mouse Interface | WIRELESS |
| | Power Cord | 1 |
| | AC Adaptor | 1 |
| | Warranty Card | 1 |
| | Quick Guide | 3 |
| | User Manual | N/A |
| | VESA Mount kit | N/A |
| | Keyboard | RF1430 |
| | Mouse | MA04 |
| Input Device | WebCam | N/A |
| Regulatory Compliance | Storage Operating Temperature Range | 0° C ~ 35° C ; -20° C ~ 60° C |
| | Storage Operating Humidity Range | 0% ~ 85%;0% ~ 90% |
| | Certifications | FCC(Class B) CB/CE UL(CUL) BSMI |
| Design | Adjustment (Tilt) | -5°~20°(+/-2°) |
| | Adjustment (Swivel) | N/A |
| | Adjustment (Height) | N/A |
| | Adjustment (Pivot) | N/A |
| Product Dimension with Stand (WxDxH) | Product Dimension with Stand (WxDxH) (mm) | 541.9 x 227.9 x 425.5 |
| | Product Dimension with Stand (WxDxH) (inch) | 21.33 x 8.97 x 16.75 |
| Dimension & Weight | Weight (Net kg) | 4.63 |
| | Weight (Gross kg) | 8 |
| | Product Dimension with Holder (WxDxH) (mm) | N/A |
| | Product Dimension with Holder (WxDxH) (inch) | N/A |
| | Inside Carton Dimension with Holder (WxDxH) (mm) | N/A |
| | Inside Carton Dimension with Holder (WxDxH) (inch) | N/A |
| | Inside Carton Dimension with Stand (WxDxH) (mm) | 620 x 223 x 486 |
| | Inside Carton Dimension with Stand (WxDxH) (inch) | 24.41 x 8.78 x 19.13 |
| | Outer Carton Dimension with Holder (WxDxH) (mm) | N/A |
| Warranty | Warranty | 24M |
| Barcode Info | EAN | 4719072948672 |